

HARBORVIEW  
MEDICAL CENTER



UW Medicine  King County

**King County**

# HARBORVIEW BOND PROGRAM\*

Focused on the  
future of Harborview

May 2023

\*The Harborview Bond Program is a King County & UW Medicine Collaboration

[KingCounty.gov/Harborview](https://kingcounty.gov/Harborview)

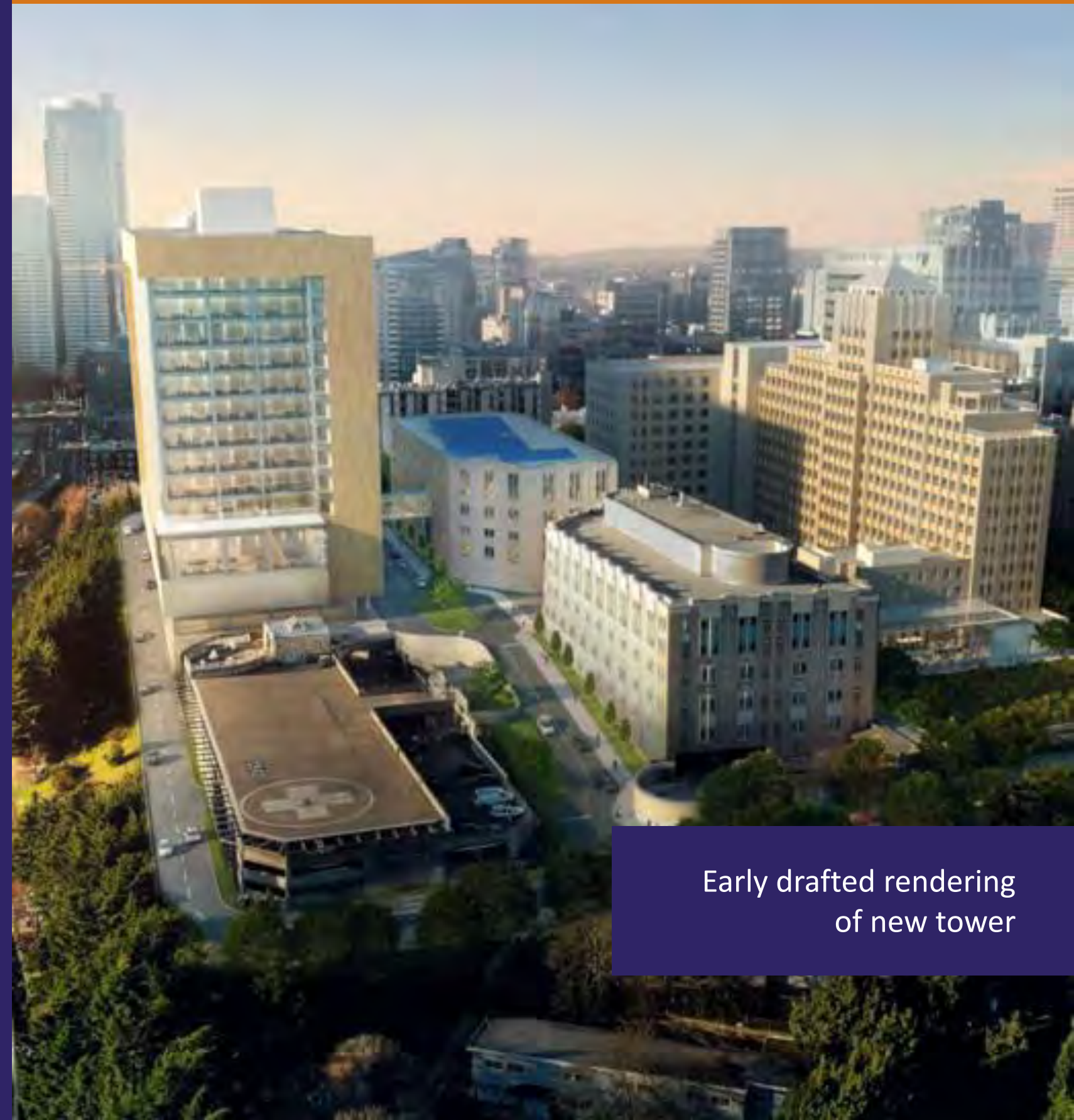

Early drafted rendering  
of new tower



# OVERVIEW

- Background
- Leading projects
- Connect with us

# ABOUT HARBORVIEW MEDICAL CENTER



**Level 1**

**Trauma Center**

serves five-state  
region



**+100%**

Works at more than  
100% capacity due to  
the growing needs



**50+ Year**

Partnership between  
King County and  
UW Medicine



# ABOUT HARBORVIEW BOND PROGRAM



**\$1.74 Billion**  
Approved by voters  
in bond funding



Construct new and modern  
healthcare facilities and seismic  
improvements

# CAMPUS IMPROVEMENTS

## NEW MEDICAL TOWER WITH PARKING



Cutting-edge research spaces



Extended innovative emergency department



Expansion of single respite beds



Improved signage and directions



# CAMPUS IMPROVEMENTS

- New Tower
- Helipads
- Loop Road
- Open Space improvements

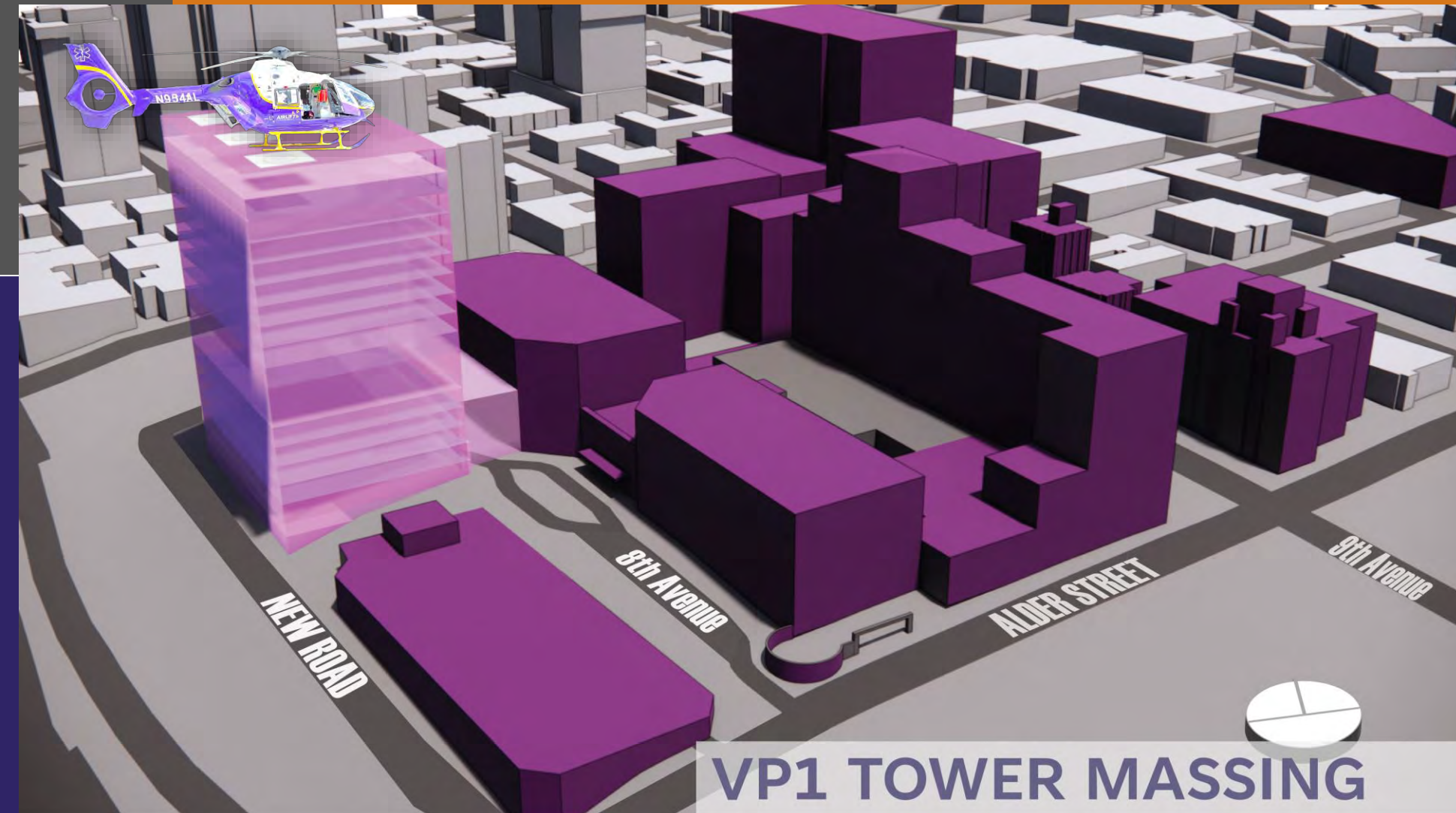

# CAMPUS OPEN SPACE

- **Terry Terrace Plaza**
  - Public space - open to all
  - Linked to Terry Ave
  - Rehabilitation uses



# CAMPUS OPEN SPACE

- **Terry Street Improvements**
  - Improved sidewalks & crosswalks
  - Street trees & landscape
  - Site amenities





# ADDITIONAL DETAILS

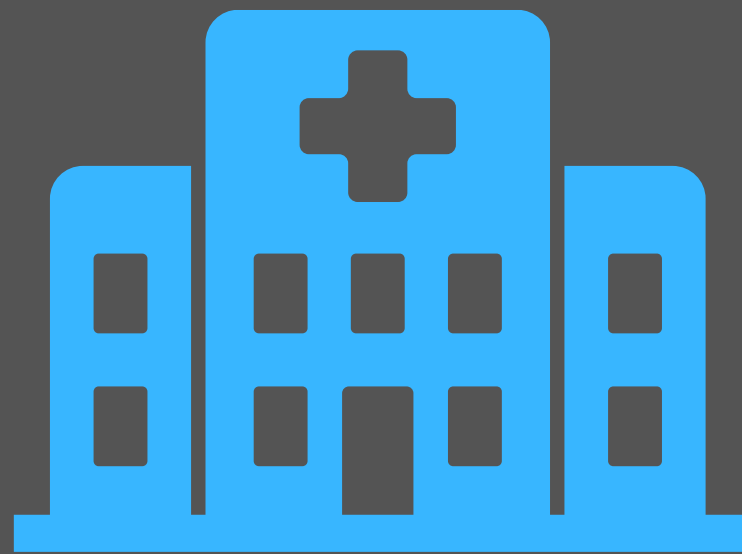

The hospital will remain **100% operable** throughout the hospital modernization.

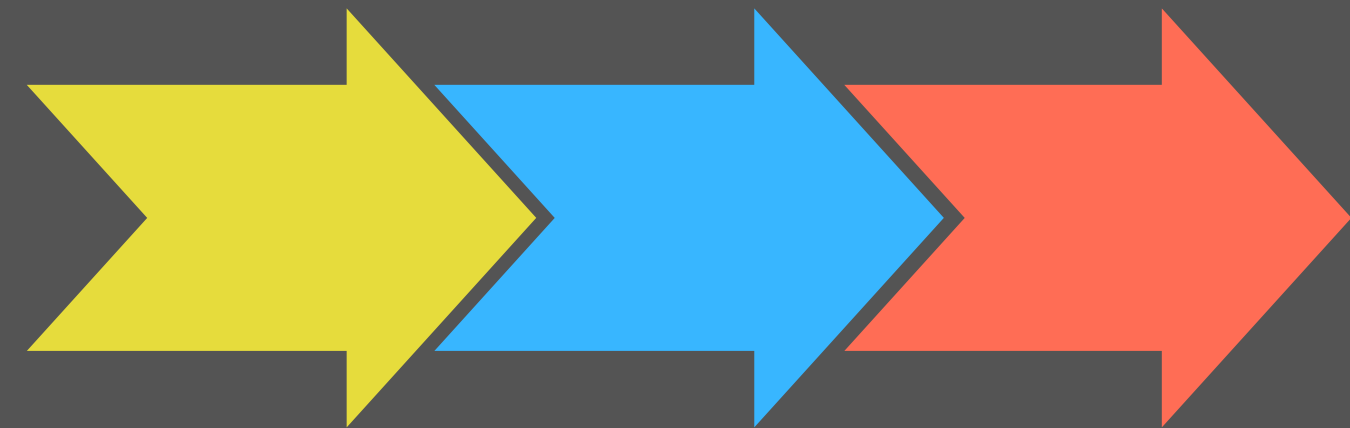

All bond projects will be **completed within five to ten years.**

# CONNECT WITH US

Sign up for our newsletter at  
[KingCounty.Gov/Harborview](https://www.kingcounty.gov/harborview)

